

Aussie Pumps

AUSSIE SPARES DIAGRAM & PARTS LIST

AUSSIE QP TRANSFER PUMP: QP60TD MITSUBISHI

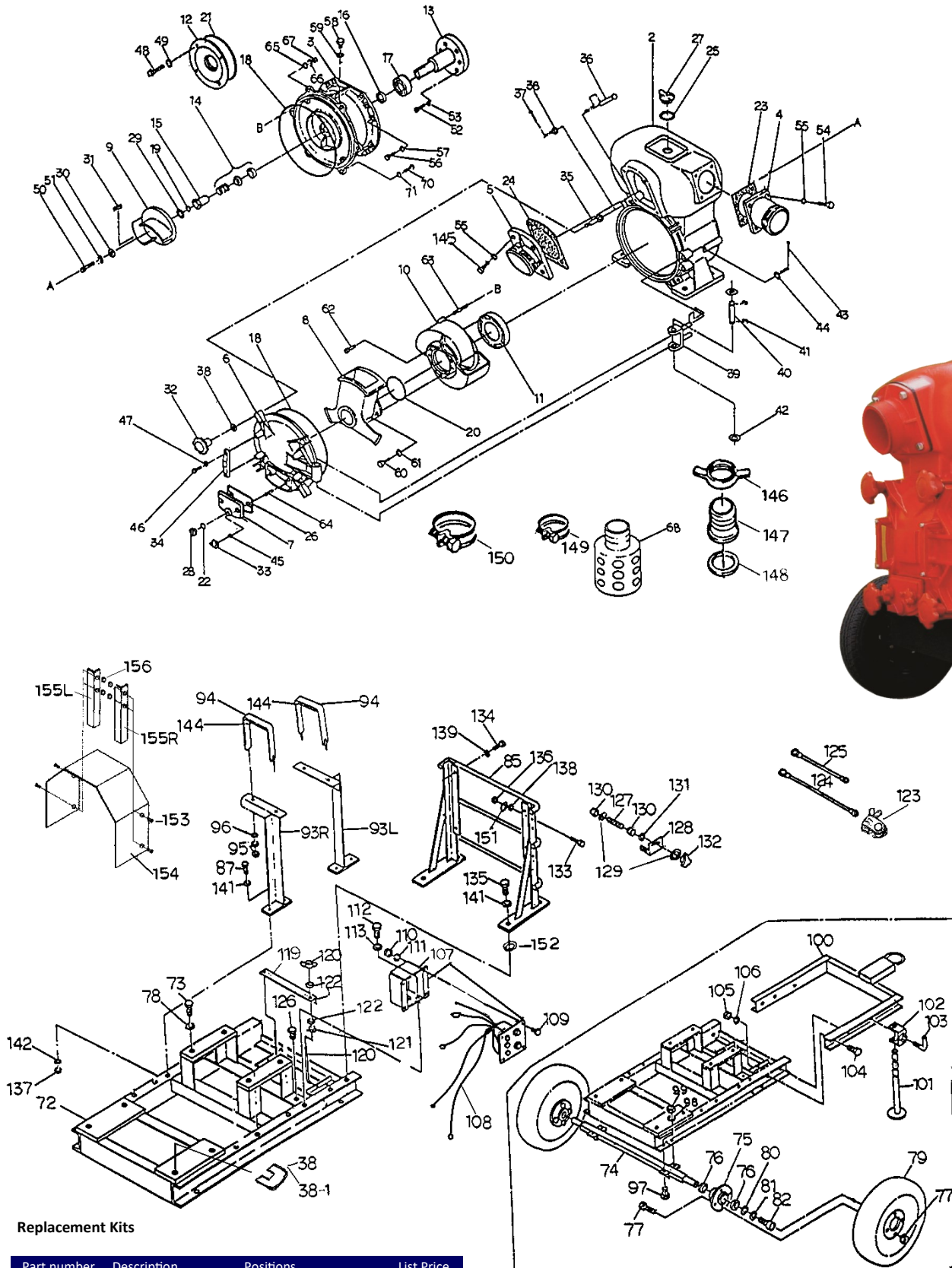

Replacement Kits

| Part number | Description | Positions | List Price |
|-------------|------------------|--|------------|
| Q60TDREJ | Rejuvenation Kit | 14, 16, 17, 18, 19, 20, 21, 25, 26, 29, 30, 31, 50, 51 | \$1,900 |
| Q60TD-ORKT | O-ring kit | 16, 18, 19, 20, 21, 23, 25, 26, 29, | \$302 |

Purchase a kit and **SAVE** on buying individual parts

FIVE YEAR WARRANTY ON ALL AUSSIE QP PUMPS
... subject to the use of genuine Aussie replacement parts.



| Position | Part number | Description | Qty | List price |
|----------|-------------------|--------------------------------------|-----|------------|
| | S3L31MJXX | ENGINE | 1 | |
| 2 | Q2601-000010-0001 | CASING | 1 | \$16,307 |
| 3 | Q2620-000023-0001 | CASING COVER | 1 | \$4,472 |
| 4 | Q4601-000090-0001 | DELIVERY COVER | 1 | \$1,316 |
| 5 | Q4601-000160-0001 | SUCTION COVER | 1 | \$1,579 |
| 6 | Q2608-000170-0001 | DRAIN COVER | 1 | \$4,076 |
| 7 | Q2601-000210-0001 | DRAIN COVER-B | 1 | \$335 |
| 8 | Q2601-000800 | SUCTION CASE | 1 | \$2,170 |
| 9 | Q2602-000032 | IMPELLER | 1 | \$1,316 |
| 10 | Q2620-000130 | VOLUTE CASING | 1 | \$3,235 |
| 11 | Q4607-000700 | WEAR PLATE | 1 | \$1,448 |
| 12 | Q4607-000750 | MECHANICAL SEAL HOUSING | 1 | \$330 |
| 13 | Q2632-221010 | PUMP SHAFT | 1 | \$2,342 |
| 14 | Q080133-4545 | MECHANICAL SEAL | 1 | \$1,890 |
| 15 | Q081138-4576 | MECHANICAL SEAL SLEEVE | 1 | \$789 |
| 16 | Q086245-6209 | OIL SEAL | 1 | \$80 |
| 17 | Q067002-6209 | BALL BEARING | 1 | \$296 |
| 18 | Q048360-4300 | O-RING (CASING, DRAIN COVER) | 2 | \$99 |
| 19 | Q048035-0380 | O-RING (MECHANICAL SEAL SLEEVE) | 1 | \$8 |
| 20 | Q048057-1400 | O-RING (VOLUTE CASING) | 1 | \$33 |
| 21 | Q048220-1000 | O-RING (MECHANICAL SEAL HOUSING) | 1 | \$17 |
| 22 | Q048035-0300 | O-RING (DRAIN CAP) | 1 | \$7 |
| 23 | Q1601-330360 | PACKING (DELIVERY COVER) | 1 | \$50 |
| 24 | Q1601-330350 | CHECK VALVE | 1 | \$645 |
| 25 | Q074132-0503 | PACKING (FLOODING CAP) | 1 | \$12 |
| 26 | Q1601-330380 | PACKING (DRAIN COVER-B) | 1 | \$71 |
| 27 | Q063121-1202-0002 | FLOODING CAP | 1 | \$171 |
| 28 | Q063121-1100ASS | DRAIN CAP WITH O-RING | 1 | \$23 |
| 29 | Q085283-6439 | ADJUST LINER | 3 | \$39 |
| 30 | Q4607-201240-0011 | IMPELLER WASHER | 1 | \$21 |
| 31 | Q051108-1054 | KEY | 1 | \$26 |
| 32 | Q2601-000190-0001 | DRAIN COVER SET HANDLE | 4 | \$211 |
| 33 | Q2601-000220-0001 | DRAIN COVER SET-B SET HANDLE | 2 | \$106 |
| 34 | Q1247-100250-0001 | DRAIN COVER HANDLE | 2 | \$48 |
| 35 | Q2601-200270-0001 | HINGE BOLT | 4 | \$106 |
| 36 | Q2601-200280-0001 | HINGE PIN | 4 | \$43 |
| 37 | Q064140-0430 | SPLIT PIN | 4 | \$1 |
| 38 | Q085283-0000 | BASE LINER | 4 | \$10 |
| 38-1 | Q085285-0000 | BASE LINER | 4 | \$10 |
| 39 | Q2601-200260-0001 | DRAIN COVER SET HINGE | 1 | \$908 |
| 40 | Q2601-200300-0001 | HINGE SET PIN | 1 | \$139 |
| 41 | Q046272-1915 | E-RING | 2 | \$7 |
| 42 | Q040145-0200 | WASHER | 2 | \$2 |
| 43 | Q064230-0528 | SPLIT PIN | 2 | \$2 |
| 44 | Q040145-0160 | WASHER | 12 | \$1 |
| 45 | Q040145-0120 | WASHER | 2 | \$1 |
| 46 | Q014105-0825 | SCREW (DRAIN COVER HANDLE) | 4 | \$1 |
| 47 | Q045125-0080 | SPRING WASHER | 4 | \$1 |
| 48 | Q010509-0820 | BOLT (MECHANICAL SEAL HOUSING) | 4 | \$3 |
| 49 | Q045129-0080 | SPRING WASHER | 4 | \$1 |
| 50 | Q010509-1225 | BOLT (IMPELLER) | 1 | \$10 |
| 51 | Q045129-0120 | SPRING WASHER | 1 | \$2 |
| 52 | Q010505-1235 | BOLT | 3 | \$3 |
| 54 | Q010505-1645 | BOLT (SUCTION COVER, DELIVERY COVER) | 4 | \$15 |
| 55 | Q045125-0160 | SPRING WASHER | 8 | \$1 |
| 56 | Q010705-1030 | BOLT (CASING COVER) | 8 | \$7 |
| 57 | Q045125-0100 | SPRING WASHER | 8 | \$1 |
| 58 | Q010505-2030-0001 | BOLT (OIL CAP) | 3 | \$86 |
| 59 | Q4607-287110 | OIL CAP WASHER | 3 | \$8 |
| 60 | Q010509-1030 | BOLT (SUCTION CASE) | 2 | \$10 |
| 61 | Q045129-0100 | SPRING WASHER | 2 | \$1 |
| 62 | Q013119-1020 | CAP SCREW (WEAR PLATE) | 3 | \$10 |
| 63 | Q015116-1035 | STUD BOLT (VOLUTE CASING) | 2 | \$47 |
| 64 | Q015115-1230 | STUD BOLT (DRAIN COVER-B) | 2 | \$12 |
| 65 | Q045822-0100 | SEAL WASHER | 2 | \$15 |
| 66 | Q045125-0100 | SPRING WASHER | 2 | \$1 |
| 67 | Q020445-0100 | U-NUT | 2 | \$8 |
| 68 | Q074221-1150 | STRAINER | 1 | \$1,184 |
| 70 | Q010505-1655 | BOLT | 10 | \$8 |
| 71 | Q045125-0160 | SPRING WASHER | 10 | \$2 |
| 72 | Q2632-214010-0005 | BASE | 1 | \$6,970 |
| 73 | Q010505-1230 | BOLT | 4 | \$3 |

| Position | Part number | Description | Qty | List price |
|----------|-------------------|-----------------------------|------|------------|
| 74 | Q2629-219040-0005 | AXLE WITH TRAY | 1 | \$1,973 |
| (74-1) | (2629-219040) | (AXLE TRAY) | | - |
| 75 | Q2620-219101-0005 | WHEEL | 2 | \$1,316 |
| 76 | Q067006-6206 | BALL BEARING | 4 | \$144 |
| 77 | Q2629-209170 | BOLT SET | 8 | \$153 |
| 78 | Q045125-0120 | SPRING WASHER | 4 | \$1 |
| 79 | Q098500-1061 | TIRE | 2 | \$1,841 |
| 80 | Q2629-209160 | WASHER | 4 | \$26 |
| 81 | Q045125-0180 | SPRING WASHER | 2 | \$2 |
| 82 | Q013115-1825 | CAP SCREW | 2 | \$46 |
| 85 | Q2632-214210-0005 | RADIATOR BASE | 1 | \$1,973 |
| 87 | Q010505-1025 | BOLT | 4 | \$2 |
| 93R | Q2632-214101-0005 | FUEL TANK BASE | 1 | \$462 |
| 93L | Q2632-214111-0005 | FUEL TANK BASE | 1 | \$462 |
| 94 | Q2632-214130-0005 | FUEL TANK BAND | 2 | \$361 |
| 95 | Q020545-0080 | NUT | 8 | \$1 |
| 96 | Q045125-0080 | SPRING WASHER | 4 | \$1 |
| 97 | Q010505-1225 | BOLT | 4 | \$3 |
| 98 | Q045125-0120 | SPRING WASHER | 4 | \$1 |
| 99 | Q020545-0120 | NUT | 4 | \$2 |
| 100 | Q2629-219050-0005 | DRAWING BAR | 1 | \$2,434 |
| 101 | Q2629-219070-0005 | STAND | 1 | \$462 |
| 102 | Q2629-219080-0005 | STAND HOLDER | 1 | \$657 |
| 103 | Q2611-209090-0005 | STAND HANDLE | 1 | \$153 |
| 104 | Q010505-1830 | BOLT | 4 | \$20 |
| 105 | Q020545-0180 | NUT | 4 | \$4 |
| 106 | Q045125-0180 | SPRING WASHER | 4 | \$2 |
| 107 | Q2629-219240-0005 | CONTROL BOX | 1 | \$1,085 |
| 108 | Q2632-996800 | HARNES (ENGINE) | 1 | \$1,046 |
| 109 | Q010505-0610 | BOLT | 4 | \$1 |
| 110 | Q020545-0060 | NUT | 4 | \$1 |
| 111 | Q045125-0060 | SPRING WASHER | 4 | \$1 |
| 112 | Q010505-0810 | BOLT | 2 | \$1 |
| 113 | Q045125-0080 | SPRING WASHER | 2 | \$1 |
| 119 | Q095021-1240-0005 | BATTERY SET PLATE | 1 | \$356 |
| 120 | Q095021-1240A | BOLT WITH NUT | 2 | \$44 |
| 121 | Q020545-0060 | NUT | 2 | \$1 |
| 122 | Q045125-0060 | SPRING WASHER | 2 | \$1 |
| 123 | Q096903-3000 | TERMINAL SET | 1set | \$270 |
| 124 | Q097209-9900 | CORD(+) | 1 | \$309 |
| 125 | Q097209-9300 | CORD(-) | 1 | \$171 |
| 126 | Q010505-0810 | BOLT | 1 | \$1 |
| 127 | Q017116-0630 | THROTTLE BOLT | 1 | \$3 |
| 128 | Q2632-219250-0005 | CONTROL PANEL | 1 | \$592 |
| 129 | Q040145-0060 | WASHER | 3 | \$1 |
| 130 | Q020445-0060 | U-NUT | 2 | \$7 |
| 131 | Q020545-0060 | NUT | 1 | \$1 |
| 132 | Q2629-992910 | KNOB NUT | 1 | \$36 |
| 133 | Q010505-0816 | BOLT | 2 | \$1 |
| 134 | Q010505-0816 | BOLT | 4 | \$1 |
| 135 | Q010505-1025 | BOLT | 4 | \$2 |
| 136 | Q020545-0080 | NUT | 2 | \$1 |
| 137 | Q020545-0100 | NUT | 4 | \$1 |
| 138 | Q045125-0080 | SPRING WASHER | 2 | \$1 |
| 139 | Q045125-0080 | SPRING WASHER | 4 | \$1 |
| 141 | Q045125-0100 | SPRING WASHER | 8 | \$1 |
| 142 | Q045125-0100 | SPRING WASHER | 4 | \$1 |
| 144 | Q2634-434270 | TANK BAND PACKING | 2 | \$80 |
| 145 | Q010505-1655 | BOLT (SUCTION COVER) | 4 | \$8 |
| 146 | Q074111-0150 | HOSE COUPLING | 2 | \$922 |
| 147 | Q074124-0150 | HOSE JOINT | 2 | \$395 |
| 148 | Q074132-1501 | HOSE COUPLING PACKING | 2 | \$179 |
| 149 | Q093225-0160 | WIRE HOSE BAND | 1 | \$35 |
| 150 | Q093225-6000 | WIRE HOSE BAND | 2 | \$45 |
| 151 | Q040145-0080 | WASHER | 4 | \$1 |
| 152 | Q040145-0100 | WASHER | 4 | \$1 |
| 153 | Q018105-0820 | BOLT SET WITH SPRING WASHER | 4 | \$2 |
| | | WATERPROOF COVER WITH | | |
| 154 | Q2632-214490-0005 | DITCH RUBBER | 1 | \$402 |
| (154-1) | (1471-338510) | (DITCH RUBBER) | (2) | |
| 155R | Q2632-204480-0005 | WATERPROOF COVER STAY | 1 | \$118 |
| 155L | Q2632-204470-0005 | WATERPROOF COVER STAY | 1 | \$118 |
| 156 | Q020915-0080 | FLANGE NUT | 1 | |

RELIABLE PRODUCTS ... RELIABLE PEOPLE