

Aussie Pumps

AUSSIE SPARES DIAGRAM & PARTS LIST

AUSSIE QP TWIN IMPELLER PUMP: QPT-205SLT/GX270
QPT-205SLT/GX390
(AFTER JULY 2009)

RENEW OR UPGRADE

YOUR PUMP WITH AN
AUSSIE WET END KIT

ONLY \$1,436

(P/N: QPT205SLTKIT SUITS GX270 OR GX390
1" SCREWED SHAFT)

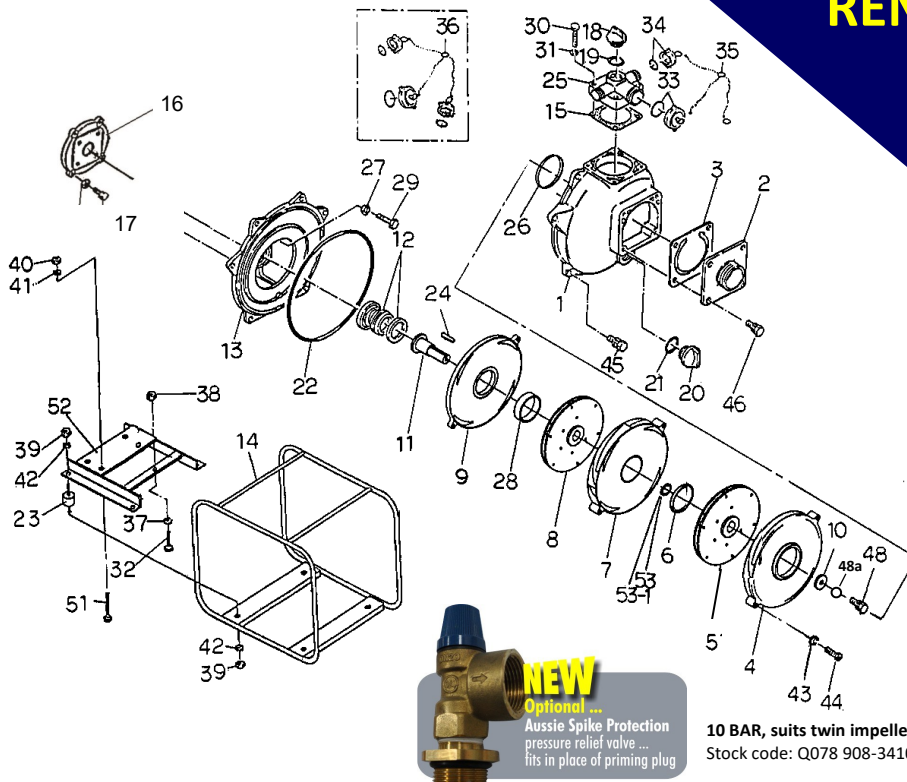

10 BAR, suits twin impeller fire pumps
Stock code: Q078 908-3410 \$225^{+GST}

Purchase a kit and **SAVE up to 30%**
on buying individual parts

Replacement Kits

KIT	Part number	Description	Positions	List Price
O	Q2055-ORKT	O RING KIT	15, 19, 21, 22, 26, 28,	\$62
P	QT205SLTREJ-2	REJUVENATION KIT (1" p shaft)	6, 12, 15, 19, 22, 26, 28	\$295
W	QT205SLTWREJ-2	REJUVENATION KIT (w shaft)	6, 12, 15, 21, 22, 26, 28	\$295
IV	Q7207-990520	IMPELLER/VOLUTE SET	4, 5, 6, 7, 8, 9, 10 26, 28, 43, 44, 48, 48a	\$997

Pos	Kit	Part number	Description	Qty	List price
37		Q045125-0080	SPRING WASHER	1	\$1
38		Q020545-0080	NUT	1	\$1
39		Q020545-0100	NUT	8	\$1
40		Q020545-0100	NUT	4	\$1
41		Q045125-0100	SPRING WASHER	4	\$1
42		Q045125-0100	SPRING WASHER	8	\$1
43	IV	Q045129-0060	SPRING WASHER	2	\$1
44	IV	Q010509-0640	BOLT	2	\$1
45		Q018105-0825	BOLT SET WITH SPRING WASHER	6	\$3
46		Q018105-0825	BOLT SET WITH SPRING WASHER	4	\$3
47		Q018105-0820	BOLT SET WITH SPRING WASHER	4	\$3
48	IV	Q010809-0820	SS BOLT M8 Hi Tension 20mm	1	\$11
48a	IV	Q045129-0080	SPRING WASHER	1	\$3
49		Q014105-0815	SCREW	4	\$1
50		Q045125-0080	SPRING WASHER	4	\$1
51		Q010505-1045	BOLT	4	\$1
52		Q1867-214020	ENGINE BASE (w shaft)	1	\$194
52		Q1988-214021	ENGINE BASE (1" p shaft)	1	\$234
53		Q085283-4230	ADJUST LINER	1	\$9
53-1		Q085285-4230	ADJUST LINER	1	\$9
56		Q7207-081300	Liner Ring 3	1	\$222

FIVE YEAR WARRANTY ON ALL AUSSIE QP PUMPS
... subject to the use of genuine Aussie replacement parts.

RELIABLE PRODUCTS ... RELIABLE PEOPLE

Pos	Kit	Part number	Description	Qty	List price
1		Q7304-100010	CASING WITH LOGO	1	\$293
2		Q1803-100160	SUCTION COVER	1	\$75
3		Q1378-350350	CHECK VALVE	1	\$74
4	IV	Q7207-060130	VOLUTE CASING	1	\$245
5	IV	Q7207-060040	IMPELLER - 2	1	\$206
6	IV, W, P	Q1878-081290	LINER RING - 2	1	\$120
7	IV	Q7207-060110	VOLUTE CASING - 2	1	\$220
8	IV	Q7207-060030	IMPELLER	1	\$398
9	IV	Q7207-060120	VOLUTE CASING - 3	1	\$193
10	IV	Q7207-251240	IMPELLER WASHER	1	\$24
11		Q1878-221010	PUMP SHAFT (w shaft)	1	\$171
11		Q1882-221010	PUMP SHAFT (1" p shaft)	1	\$171
12	W	Q080611-3325	MECHANICAL SEAL (w shaft)	1	\$320
12	P	Q080311-2930	MECHANICAL SEAL (1" p shaft)	1	\$320
13		Q4359-100020	MOUNTING FLANGE (w shaft)	1	\$228
13		Q1988-100020	MOUNTING FLANGE (1" p shaft)	1	\$237
14		Q1867-214010	FRAME (w shaft)	1	\$237
14		Q1977-214011	FRAME (1" p shaft)	1	\$237
15	O, P, W	Q1803-330360	DELIVERY COVER PACKING	1	\$15
16		Q1369-000600	CASING COVER SET PLATE -A (w shaft)	1	\$135
16		Q4357-000600	CASING COVER SET PLATE (1" p shaft)	1	\$136
17		Q019116-0625	BOLT	4	\$1
18		Q063121-1100ASS	FLOODING CAP WITH O-RING	1	\$21
19	O,P	Q048035-0300	O-RING (FLOODING CAP)	1	\$6
20		Q063121-1100ASS	DRAIN CAP WITH O-RING	1	\$21
21	O,W	Q048035-0300	O-RING (DRAIN CAP)	1	\$6
22	O,P,W	Q048935-2550	O-RING (CASING)	1	\$29
23		Q072330-2040	CUSHION RUBBER	4	\$19
24		Q051004-0443	KEY	1	\$14
25		Q1814-100090	DELIVERY COVER (3 WAY OUTLET)	1	\$87
26	O,P,W,IV	Q048220-0750	O-RING (VOLUTE CASING)	1	\$13
27		Q045822-0080	SEAL WASHER	4	\$6
28	O,P,W,IV	Q1803-521220	LINER RING	1	\$39
29		Q010505-0820	BOLT	4	\$1
30		Q010505-0845	BOLT	4	\$1
31		Q045125-0080	SPRING WASHER	4	\$1
32		Q010505-0850	BOLT	1	\$1
36		QCAPS&CHAINS	BALL CHAIN WITH CAP	1	\$81

Aussie Pumps

AUSSIE SPARES DIAGRAM & PARTS LIST

AUSSIE QP TWIN IMPELLER PUMP: QPT-205SLT/L100
(YANMAR DIESEL)

RENEW OR UPGRADE

YOUR PUMP WITH AN
AUSSIE WET END KIT

ONLY \$1,436

(P/N: QPT205SLDKIT SUITS L100
1" SCREWED SHAFT)

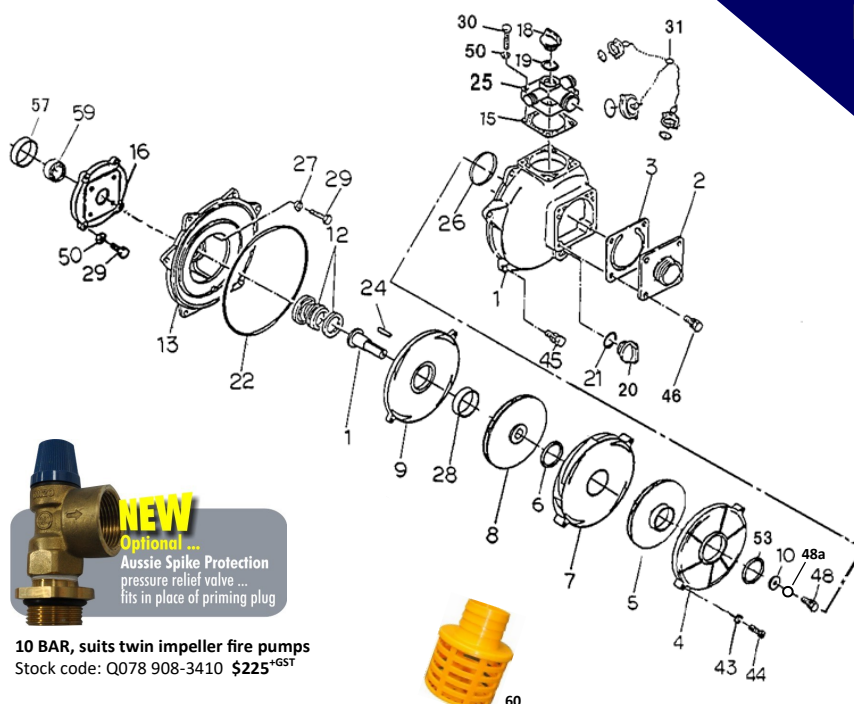

Purchase a kit and **SAVE** up to **30%**
on buying individual parts

Replacement Kits

KIT	Part number	Description	Positions	List Price
O	Q2055-ORKT	O RING KIT	15, 19, 21, 22, 26, 28,	\$62
P	QT205SLTREJ-2	REJUVENATION KIT (1" p shaft)	6, 12, 15, 19, 22, 26, 28	\$295
IV	Q7207-990520	IMPELLER/VOLUTE SET	4, 5, 6, 7, 8, 9, 10, 26, 28, 43, 44, 48, 48a	\$997

Pos	Kit	Part number	Description	Qty	List price
43	IV	Q045129-0060	SPRING WASHER	2	\$1
44	IV	Q010509-0640	BOLT	2	\$1
45		Q018105-0825	BOLT SET WITH SPRING WASHER	6	\$3
46		Q018105-0825	BOLT SET WITH SPRING WASHER	4	\$3
47		Q018105-0820	BOLT SET WITH SPRING WASHER	4	\$3
48	IV	Q010809-0820	SS BOLT M8 Hi Tension 20mm	1	\$11
48a	IV	Q045129-0080	SPRING WASHER	1	\$3
49		Q014105-0815	SCREW	4	\$1
53		Q085283-4230	ADJUST LINER	1	\$9
53-1		Q085285-4230	ADJUST LINER	1	\$9
56		Q7207-081300	Liner Ring 3	1	\$222
57		Q2261-220580	BEARING SPACER	1	\$73
59		Q067002-6909	BALL BEARING	1	\$120
60		QSTRAINER2"	2" POLY STRAINER	1	\$40

FIVE YEAR WARRANTY
ON ALL AUSSIE QP PUMPS
... subject to the use of genuine
Aussie replacement parts.



RELIABLE PRODUCTS ... RELIABLE PEOPLE

Australian Pump Industries Pty Ltd | 7 Gladstone Road, Castle Hill NSW 2154 | P: 02 8865 3500 | F: 02 9894 4240 | www.aussiepumps.com.au

All prices exclude GST

QP205SLT/FEB21/1

Aussie Pumps

AUSSIE SPARES DIAGRAM & PARTS LIST

AUSSIE QP TWIN IMPELLER PUMP: QPT-205SLT/OC95E
(KUBOTA DIESEL)

RENEW OR UPGRADE

YOUR PUMP WITH AN
AUSSIE WET END KIT

ONLY \$1,436

(P/N: QPT205SLTDKITKUB OC95E
1" SCREWED SHAFT)

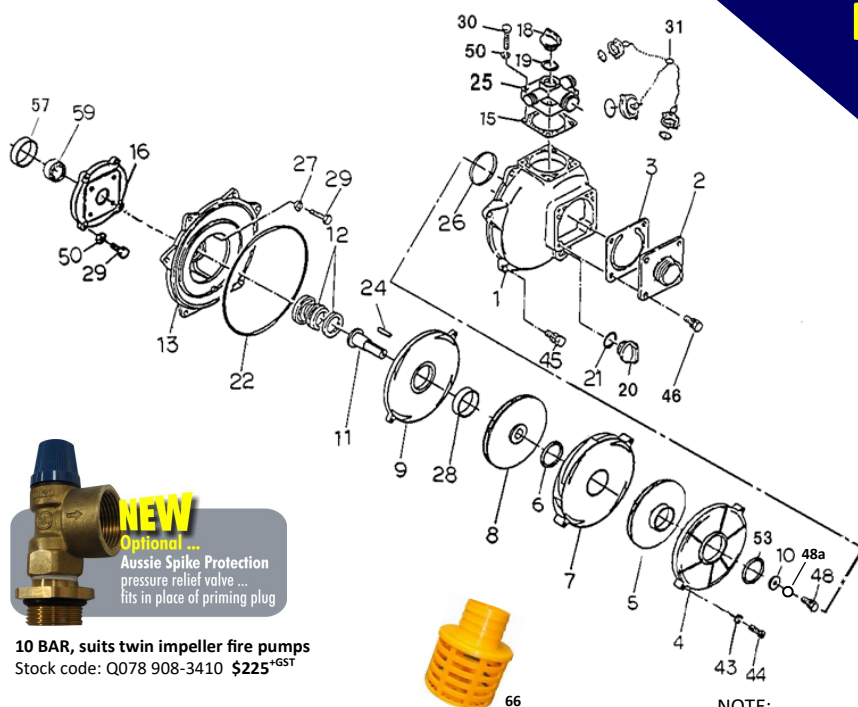

NOTE:



NEW
Optional ...

Aussie Spike Protection
pressure relief valve ...
fits in place of priming plug

10 BAR, suits twin impeller fire pumps
Stock code: Q078 908-3410 \$225^{16ST}

Pos	Kit	Part number	Description	Qty	List price
1		Q7304-100010	CASING WITH LOGO	1	\$293
2		Q1803-100160	SUCTION COVER	1	\$75
3		Q1378-350350	CHECK VALVE	1	\$74
4	IV	Q7207-060130	VOLUTE CASING	1	\$245
5	IV	Q2275-060040	IMPELLER - 2	1	\$206
6	IV, P	Q1878-081290	LINER RING - 2	1	\$120
7	IV	Q7207-060110	VOLUTE CASING - 2	1	\$220
8	IV	Q2275-060030	IMPELLER	1	\$398
9	IV	Q7207-060120	VOLUTE CASING - 3	1	\$193
10	IV	Q7207-251240	IMPELLER WASHER	1	\$24
11		Q1882-221010	PUMP SHAFT (OC95/L100)	1	\$171
12	P	Q080311-2930	MECHANICAL SEAL (OC95/L100)	1	\$320
13		Q1988-100020	MOUNTING FLANGE (OC95/L100)	1	\$237
15	O,P	Q1803-330360	DELIVERY COVER PACKING	1	\$15
16		Q2261-000600	CASING COVER SET PLATE (OC95)	1	\$201
18		Q063121-1100	FLOODING CAP WITH O-RING	1	\$21
19	O,P	Q048035-0300	O-RING (FLOODING CAP)	1	\$6
20		Q063121-1100	DRAIN CAP WITH O-RING	1	\$21
21	O	Q048035-0300	O-RING (DRAIN CAP)	1	\$6
22	O,P	Q048935-2550	O-RING (CASING)	1	\$29
24		Q051004-0443	KEY	1	\$14
25		Q1814-100091	DELIVERY COVER (3 WAY OUTLET)	1	\$87
26	O,P,IV	Q048220-0750	O-RING (VOLUTE CASING)	1	\$13
27		Q045822-0080	SEAL WASHER	4	\$6
28	O,P,IV	Q1803-521220	LINER RING	1	\$39
29		Q019117-0625	BOLT	4	\$1
30		Q018105-0825	BOLT	4	\$1
31		QCAPS&CHAINS	BALL CHAIN WITH CAPS	1	\$81
32		Q095021-1220A	BATTERY SET KIT	2	
33		Q010605-0825	BOLT	4	
36		Q096902-2000	TERMINAL SET	1set	
37		Q020545-0100	NUT	4	
38		Q045125-0100	SPRING WASHER	4	
39		Q097209-9300	SHORT CORD	1	
40		Q097209-9450	LONG CORD	1	
41		Q096120-3035D	BATTERY	1	
42		Q072330-3032	CUSHION RUBBER	4	

**FIVE YEAR WARRANTY
ON ALL AUSSIE QP PUMPS**

... subject to the use of genuine Aussie replacement parts.

Purchase a kit and **SAVE** up to **30%**
on buying individual parts

Replacement Kits

KIT	Part number	Description	Positions	List Price
O	Q2055-ORKT	O RING KIT	15, 19, 21, 22, 26, 28,	\$62
P	QT205SLTREJ-2	REJUVENATION KIT (1" p shaft)	6, 12, 15, 19, 22, 26, 28	\$295
IV	Q7207-990510KUB	IMPELLER/VOLUTE SET	4, 5, 6, 7, 8, 9, 10, 26, 28, 43, 44, 48, 48a	\$997

Pos	Kit	Part number	Description	Qty	List price
43	IV	Q045129-0060	SPRING WASHER	2	\$1
44	IV	Q010509-0640	BOLT	2	\$1
45		Q018105-0825	BOLT SET WITH SPRING WASHER	6	\$3
46		Q018105-0825	BOLT SET WITH SPRING WASHER	4	\$3
48	IV	Q010809-0820	SS BOLT M8 Hi Tension 20mm	1	\$11
48a	IV	Q045129-0080	SPRING WASHER	1	\$3
50		Q045125-0080	SPRING WASHER	13	
51		Q2276-184010	FRAME	1	
52		Q2275-184020	ENGINE BASE		
53		Q7207-081300	LINER RING 3	1	\$222
54		Q010505-0889	BOLT		
55		Q010505-1060	BOLT	4	
56		Q020545-0080	NUT	9	
57		Q2261-220580	BEARING SPACER	1	\$73
59		Q067002-6909	BALL BEARING	1	\$120
60		Q2390-212600	CONTROL BOX	1	
61		Q010505-0810	BOLT	1	
62		Q020915-0080	FLANGE NUT	1	
63		Q014105-0512	SCREW	5	
64		Q045125-0050	SPRING WASHER	5	
65		Q2275-996800	HARNES	1	
66		QSTRAINER2"	2" POLY STRAINER	1	\$40



RELIABLE PRODUCTS ... RELIABLE PEOPLE