

## AUSSIE GMP PUMPS: B2KQ-A/X "W" WITH OR WITHOUT PULLEY CAT ASA5

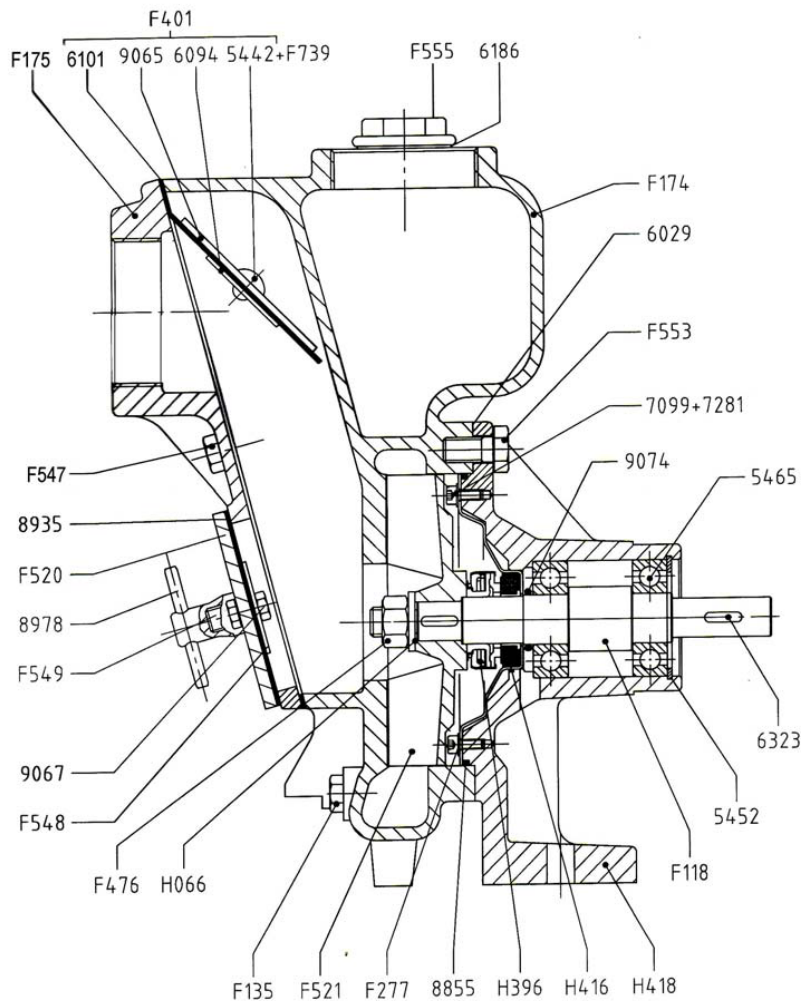

Part Number	Qty	Description	Retail price
5442	1	S/Steel OEB Screw M6x15	\$5
5452	1	Snap Ring I 47	\$7
5465	2	Bearing 6204 2RS	\$41
6029	1	Flex. Gasket B 2618	\$8
6101	1	Check Valve 2616/2	\$26
6186	1	Flex. Washer 33x39x2	\$2
6323	1	Key B 4x4x15	\$5
H396	1	Mech. Seal 19-39-13	\$48
H416	1	Counterface 21-38-8	\$104
8935	1	Gasket Inspect. Door	\$22
8978	2	Complete Pin M8	\$43
9064	1	Counterweight Washer	\$36
9065	1	Counterweight	\$47
9067	2	Nut TE M6x12	\$2
	1	Diaphragm SCH-2801/A	
9159	1	Seal Ring 19x31x3	\$17

Part Number	Qty	Description	Retail price
	1	Support B-2612/A	
F118	1	Shaft AISI 316	\$328
F135	1	Conical Tap 1/4" Gas	\$22
F174	1	Stainless Steel Pump Casing	\$3,841
F175	1	Valve B2KQ-A AISI 316	\$858
F476	1	Nut M12x1.75	\$14
F520	1	Inspection Door	\$112
F521	1	Stainless Steel Impeller 3-Bl.	\$887
F547	4	Screw M8x20 AISI 316	\$4
F548	1	Washer D.6.5x24x2	\$2
F549	2	Screw M8x40 AISI 316	\$10
F553	4	Stainless Steel Screw M10x18	\$4
F555	1	Tap AISI 316 1"G	\$116
F739	1	Steel Nut M6x1	\$7
H066	1	Washer D.13x24x2.5	\$5