

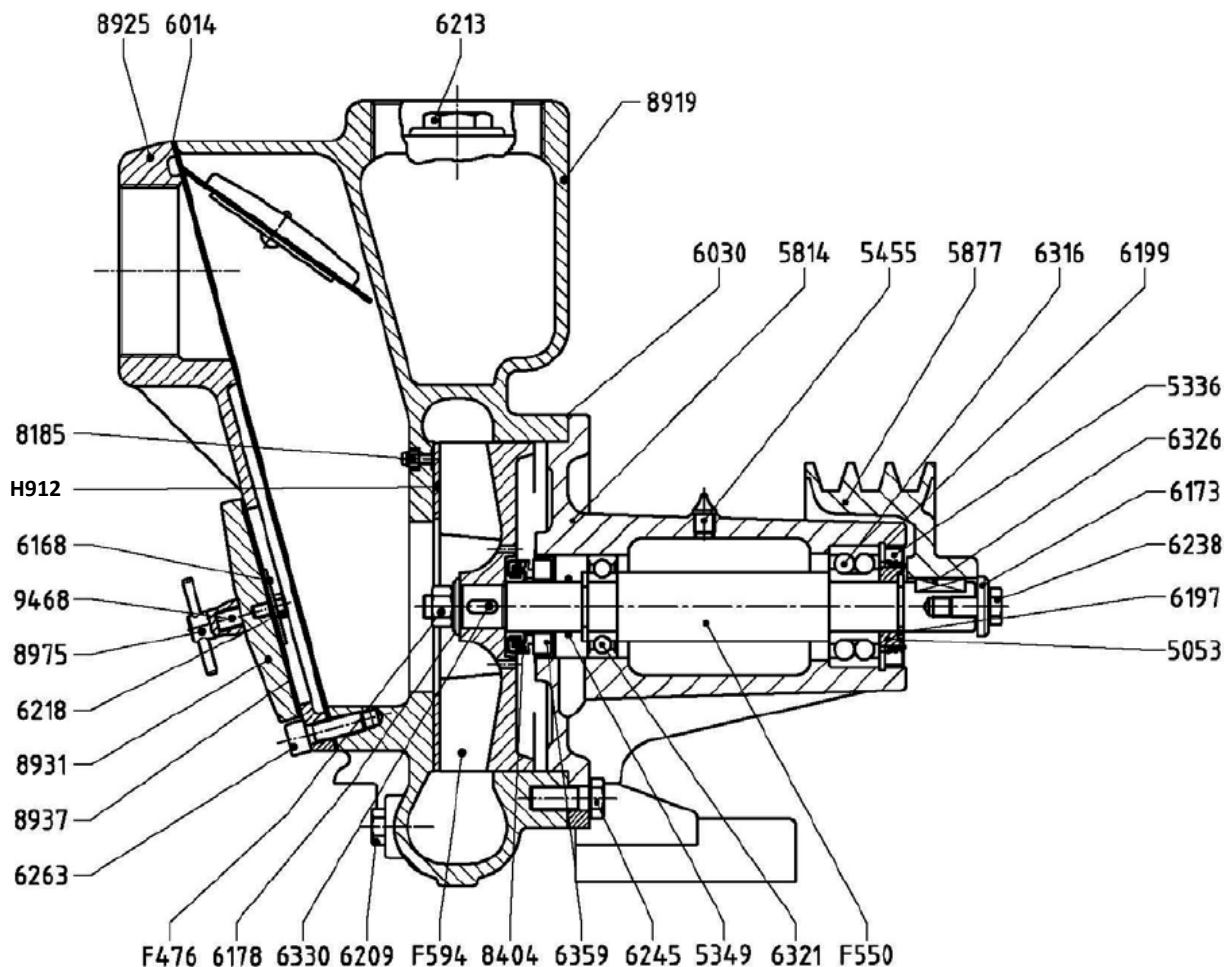

AUSSIE SPARES DIAGRAM & PARTS LIST

AUSSIE GMP PUMPS: B3XR-A/ST "W" WITH OR WITHOUT PULLEY
CAT AS91



Part Number	Qty	Description	List price
5053	1	Sleeve G 1005/1	\$24
5336	1	Oil seal 40x62x10	\$14
5349	1	Or 4093 (23.4x3.53)	\$4
5441	2	Flex gasket 0.2mm	\$12
5455	1	Greaser G 1/8"	\$7
5814	1	Support B3XR-A	\$992
6014	1	Complete check valve	\$96
6030	1	Flex. Gasket G 1089	\$12
6186	1	Filling cap gasket	\$7
6161	1	Washer D.7x75x2.5	\$11
6168	1	Washer B 2621/2	\$7
6169	2	Copper Washer	\$4
6173	1	Washer 10x30x6	\$7
6178	1	Washer B 2901/2	\$5
6197	2	Snap ring E 25	\$2
6199	1	Snap ring I 62	\$5
6209	1	Conical Tap 1/4" Gas	\$6
6213	1	Conical Tap 1" Gas	\$7
6218	1	Hex. Head Screw M6x12	\$2
6238	1	Screw T.E. M10x20 SX	\$7
6243	4	T.E. Screw M 12x25	\$6
6263	5	OEB Screw M 10x30	\$2
6316	1	Bearing 3305	\$182
6321	1	Bearing 6205-2RS	\$61
6326	1	Key B 6x6x25	\$6

Part Number	Qty	Description	List price
6330	1	Key 6x6x15	\$5
P297	1	Counterface 1002/4	\$55
6841	1	Rivet 6.5x20	\$4
8185	3	Torque Nut M5 A2	\$4
8404	1	Mech. Seal 25-47-14	\$268
8919	1	Pump Casing B3XR-A/ST	\$2,264
8925	1	Valve Body B3XR-A/ST	\$464
8931	1	Inspection Door	\$122
8937	1	Gasket for Inspect. Door	\$18
H912	1	Complete Stainless Steel Wear Disc	\$150
8975	2	Complete Pin M10	\$54
F159	3	Washer	\$6
F476	1	Nut M12x1.75	\$14
F550	1	Shaft stainless steel AISI 316	\$595
F594	1	Impeller B3XR-A/ST	\$778
H342	2	Screw M 10 x 55	\$11
F685	1	Flexolite gasket	\$8

REJUVENATION KIT ... **SAVE** ON BUYING INDIVIDUAL PARTS

GSKIT-B3XR-A/STW	Includes check valve, mech seal, counterface, filling cap & trash port gaskets (items highlighted yellow)	\$329
------------------	-----------------------------------------------------------------------------------------------------------	-------