

# IDROBASE®

PASSION FOR WATER    

**GB** Operator's Manual

# Stella

# CE



From serial number  
1121001 onwards



idrobaser®

## FAST GUIDE FOR CORRECT USE OF AUSSIE STELLA HOT WATER PRESSURE CLEANER



Refer to User Manual for guidance on all safety precautions to be taken when using hot water pressure cleaners and for full set of instructions.



### ELECTRICAL SUPPLY

1. The power supply must correspond to the rating of the hot water machine.
2. The hot water machine must be earthed and be used with a circuit breaker.
3. Do not use extension leads.

### DIESEL

1. Diesel fuel must be uncontaminated.
2. Never let the diesel fuel tank run dry.

### STANDARD USE

1. Turn on the machine from the control panel, keeping the gun open. Wait for steady pressure.
2. Wind BY-PASS valve up to highest setting (for maximum flow).
3. Set thermostat to required temperature.
4. To turn off the machine, turn the thermostat to “OFF” and wait for the jet of water to cool before turning off the machine.

### USING STEAM

1. Turn on machine from the control panel, keeping the gun open. Wait for steady pressure.
2. Wind BY-PASS valve down to lowest setting (reduces flow to minimum).
3. Turn thermostat to required “STEAM” setting.
4. **Do not release the gun trigger** when working in the steam mode.
5. To turn off the machine, turn the thermostat to “OFF”, adjust unloader to highest position and run unit on ‘cold’ for a minimum of five minutes to ensure coil is cool before turning off machine.

### DO NOT....

1. Do not run the machine in BY-PASS for more than three continuous minutes.
2. Do not leave machine unattended unless switched off.
3. Do not use machine if there is water leaking from the hose or the gun/lance.
4. Do not leave machine in environmental conditions below 5° C.
5. Do not remove the gun, the lance or hose without first relieving the pressure in hose.
6. Never tamper with the BY-PASS valve settings. These are factory set.
7. Never close the gun when using steam.
8. Never stop the machine after using steam and without having first cooled it down.
9. Do not use the machine with dirty water.

*Not following these procedures could damage the machine and void warranty.*

**AUSTRALIAN PUMP**

RELIABLE PRODUCTS ... RELIABLE PEOPLE



1	Application	pag.	36
1-1	General warning	pag.	36
1-2	Dataplate with “CE” mark	pag.	36
1-3	Warranty	pag.	36
1-4	Conditions for returns	pag.	36
1-5	Cases in witch the manufacturer is not liable	pag.	37
1-6	Safety	pag.	37
1-7	Symbols	pag.	37
1-8	Glossary	pag.	38
1-9	Notes on the labels	pag.	38
2	Product presentation	pag.	39
2-1	Purpose	pag.	39
2-2	Composition	pag.	39
3	Layout of the manual	pag.	40
3-1	Information	pag.	40
4	Technical data and specifications	pag.	41
4-1	Technical data	pag.	41
5	Unpacking and installation	pag.	42
5-1	Unpacking	pag.	42
5-2	Inactivity	pag.	42
5-3	Transport	pag.	43
5-4	Halding	pag.	43
5-5	Standard equipment	pag.	43
5-6	Installation and connection	pag.	43
5-7	Cleaning and disinfecting	pag.	45
5-8	Reinstallation and reuse	pag.	45
5-9	Destruction and disposal	pag.	45
6	Operation and use	pag.	46
6-1	Description of operation	pag.	46
6-2	Range of applications	pag.	46
6-3	Intended usage	pag.	46
6-4	Working limits	pag.	47
6-5	Positioning of the operator and danger area	pag.	47
6-6	Safety features and working indications	pag.	47
6-7	Persistent hazards	pag.	49
6-8	Safety gear for the operator	pag.	49
6-9	Training	pag.	49
7	User istructions	pag.	49
7-1	Description of the safety controls	pag.	49

7-2	Manoeuring description to be carried out and operation	pag.	49
7-3	Trial stage	pag.	50
7-4	Interrupting the running (total stop)	pag.	50
7-5	Work stoppage	pag.	51
7-6	Regulation	pag.	51
7-7	Stopping and pausing operation	pag.	51
7-8	Stopping operation	pag.	51
7-9	Emergency stop	pag.	51
7-10	Resetting conditions	pag.	51
7-11	Storage operation	pag.	52
8	Maintenance	pag.	53
8-1	Regular maintenance	pag.	53
8-2	Extraordinary maintenance	pag.	54
8-3	Technical information	pag.	54
9	Troubleshooting	pag.	55
10	Spare parts	pag.	56
10-1	Spare parts	pag.	56
10-2	Spare parts	pag.	56
11	Destruction disposal	pag.	57
11-1	Destruction disposal	pag.	57
	Declaration of conformity	pag.	60

## 1-1) GENERAL WARNINGS



BEFORE INSTALLING AND USING THE MACHINE IT IS COMPULSORY THAT THE INSTALLER AND USERS READ AND UNDERSTAND ALL OF THE INFORMATION IN THIS MANUAL. THIS MANUAL IS AN INTEGRAL PART OF THE MACHINE; IT MUST ALWAYS BE AVAILABLE DURING THE NORMAL OPERATION OF THE MACHINE AND IT IS IMPERATIVE THAT IT IS RETAINED FOR FUTURE REFERENCE UNTIL THE DISPOSAL OF THE MACHINE



THE COPYRIGHT OF THIS MANUAL "INSTRUCTION FOR INSTALLATION AND USE" IS THE PROPERTY OF IDROBASE S.R.L. ALL OF THE INFORMATION (TEXT, DRAWINGS, DIAGRAMS, ETC..) CONTAINED IN THIS MANUAL IS CONFIDENTIAL. NO PART OF THIS MANUAL CAN BE REPRODUCED AND DISTRIBUTED (EITHER IN PART OR COMPLETE) BY ANY MEANS OF REPRODUCTION, (PHOTOCOPIES, MICROFILM, OR OTHER) WITHOUT WRITTEN AUTHORIZATION FROM IDROBASE S.R.L.

## 1-2) DATAPLATE WITH "CE" MARK

### MACHINE IDENTIFICATION

The machine is distinguished by a manufacturer's plate

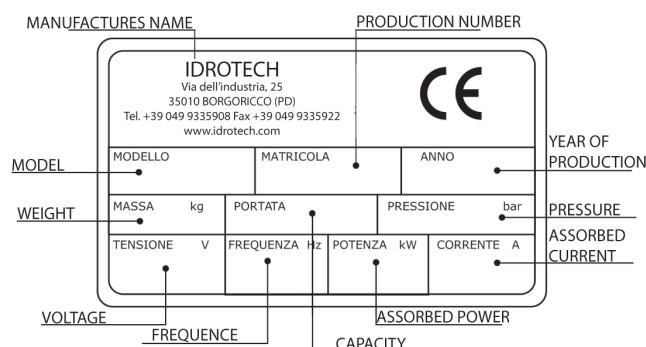

## 1-3) WARRANTY

All of our apparatus are subjected to accurate and rigorous tests and are covered under warranty in accordance with statutory law from manufacturing defects.



THE WARRANTY IS INVALIDATED IF THE USE OF THE MACHINE DOES NOT CONFORM TO THE INSTRUCTIONS FOR USE CONTAINED IN THIS MANUAL, AND IF THE ORIGINAL COMPONENTS, ACCESSORIES, SPARE PARTS AND CONTROL SYSTEMS ARE NOT USED.

The warranty starts from the date of purchase.

The valid date of purchase is that indicated on the receipted or invoice issued at the time the equipment is delivered by the retailer. IDROBASE undertakes to repair or replace free of charge any parts that have manufacturing faults within the warranty period. Faults not clearly due to materials or manufacturing shall be examined at one of our Technical Assistance Centres or at our headquarters and charged according to the results. The following are excluded from the warranty: accidental damage due to transport, negligence or inappropriate treatment, incorrect or improper use or installation, i.e. not complying to the instruction manual, and any situations that do not depend on machine standards and operation, or on electrical and equipment use. The warranty is invalidated if the equipment is repaired or tampered with by unauthorised third parties. The equipment shall not be replaced nor the warranty extended after it has been repaired for faults. The warranty does not cover cleaning the working parts or replacing consumable components such as pump oil, nozzle, lances, etc. IDROBASE is not liable for any damage to persons or objects due to incorrect installation or improper use of the equipment.

## 1-4) CONDITIONS FOR RETURNS

It will be the responsibility of the end user to return the product to the retailer; or telephone +39 049 9335136 for more information.

## 1-5) CASES IN WHICH THE MANUFACTURER IS NOT LIABLE

The manufacturer is not liable for damage caused by the following :

- Improper use of the machine or use by untrained personal.
- Use of non genuine spare parts.
- Non-compliance with maintenance.
- Unauthorized modifications or operation
- Non-observance, in total or part, of the instruction manual

## 1-6) SAFETY

To guarantee a long pump life, it is forbidden to circulate liquids with sand or other solid particles that compromise the efficient running of the valves, pistons and seals. Fit any other filters to the waterfeeding circuit.

Only environmentally friendly chemicals which are fully biodegradable should be used in the machine

Do not use paints, adds, solvents, oily or very dense materials. Never use the machine in or near any flammable products or environments (e.g. gas or petrol fumes).

Protect the machine from extreme cold and adverse weatherconditions. Avoid starting in extremely cold conditions as damage may occur to the pump and motor The machine should only be used by an adult perator who has been suitably trained. Never leave the machine unattended when It is switched on or if children are present.

Do not use the machine in the presence of unauthorized personnel or persons who are not wearing suitable protective garments.

Although a suitable grip is provided with the lance, the water pressure at the start of the discharge from the nozzle (opening of the trigger) produces a REACTIVE FORCE (recoil) which needs to be COUNTERBALANCED.

The necessary counterbalance force required is shown In the table below and is expressed in Newlons.

This equipment has been designed for use with the detergentrecommended by the manufacturer The use of other deter-gents or chemical products other than those specified may af-fect the safety of the equipment.

## 1-7) SYMBOLS

In this manual the symbols depicted describe important functions of the machine; for the installation; for the use and disposal. For correct and safe use of the machine the operator must read carefully all parts of this manual lending special attention to the warning symbols and manufacturer's plate.



### PAY ATTENTION TO SAFETY IN THE WORKPLACE!

Follow the instructions displayed on the warning signs. Failure to do so may cause severe injury or endanger personal safety. Ensure that the signs are present and legible. If they are not, they should be fitted or replaced.



This manual must be read before using or carrying out maintenance or other operations on the machine. Do not allow unauthorized personnel to use the machine

## 1-8) GLOSSARY

The following symbols advise the operator of dangerous situations or the important operations for the correct running of the machine.

### WARNING SIGNS

This manual must be read before using or carrying out maintenance or other operations on the machine.

#### INFORMATION



The informations contained in this manual shows the right procedures for the correct maintenance and use of the machine

#### WARNING



The caution indicates special procedures that if not observed can cause damage to persons or property.

#### WARNING



Maintenance or repairs must never be carried out while the machine is live/switched on. Always disconnect from the electrical supply before carrying out repairs or removing the cover.

#### WARNING



Avoid storing or using the machine in extreme temperatures. Frost may cause serious damage to the high pressure pump.

#### WARNING



Protective garments should be worn

#### WARNING



This manual must be read before using.

#### WARNING



Only use recommended liquid detergents. the use of other materials may endanger the safety of the user or damage the machine.

#### WARNING



Do not aim the jet at electrical sockets, people, animals, or in order to clean clothes or footwear. The high pressure jet can be dangerous if used inappropriately.

## 1-9) NOTES ON THE LABELS

Never remove the labels from the machine. If they have deteriorated, ask your retailer or the manufacturer directly for a replacement.



THE MANUFACTURER IS NOT LIABLE IN ANY WAY IN THE EVENT OF ACCIDENTS OR BREAKAGE DUE TO NON-OBSERVANCE OF THE WARNINGS.



IN CASE OF ANY CONFUSION REGARDING ANYTHING IN THIS MANUAL CONTACT THE RETAILER IMMEDIATELY



THE STICKER SHOWING THE WAY OF USE AND RESTRICTIONS HAS NEVER TO BE REMOVED FROM THE CASE WHERE IT IS.

### 2-1) PURPOSE

The high pressure washer Stella was conceived to be the best tool for pressure cleaning in industries like shipyards, heavy road haulage, construction machinery, industrial machine shops, industrial tanning, food industry, etc. The machine can be used in the cleaning, for example of, motor parts, production machinery encrusted with oil, layers of combustible waste products, the removal of barnacles encrusted on ship hulls, washing trailers encrusted with salt (salt on the streets in winter), greasy smog, also to wash trains, buses, and anywhere paint is covered by layers of dirt and grime.

### 2-2) COMPOSITION

Referring to the picture below, the pressure washer is composed of a stainless steel frame, equipped with wheels, and with a plate on which are fitted the motor, pump, regulating valve, control panel, and hoses. The heating unit which produces hot water, is composed of an electric motor, diesel pump, filter and heating coil, and is attached between the base and the handlebars. At the front of the machine is placed the diesel tank which is equipped with a visible level indicator to determine the amount of diesel remaining, and at the back there is the water tank with a floating switch inside..

N°	Descrizione	N°	Descrizione
1	FRAME	2	PROTECTION OF THE COVER
3	HEATER	4	MOTOR PUMP
5	ELECTRIC PANEL WITH THERMOSTAT	6	BY PASS
7	FUEL TANK	8	WHEEL
9	HYDRO SPRAY GUN	10	WASHING LANCE
11	DETERGENT HOSE	12	HIGH PRESSURE HOSE
13	WHEEL STUDS	14	UNIT HANDLE

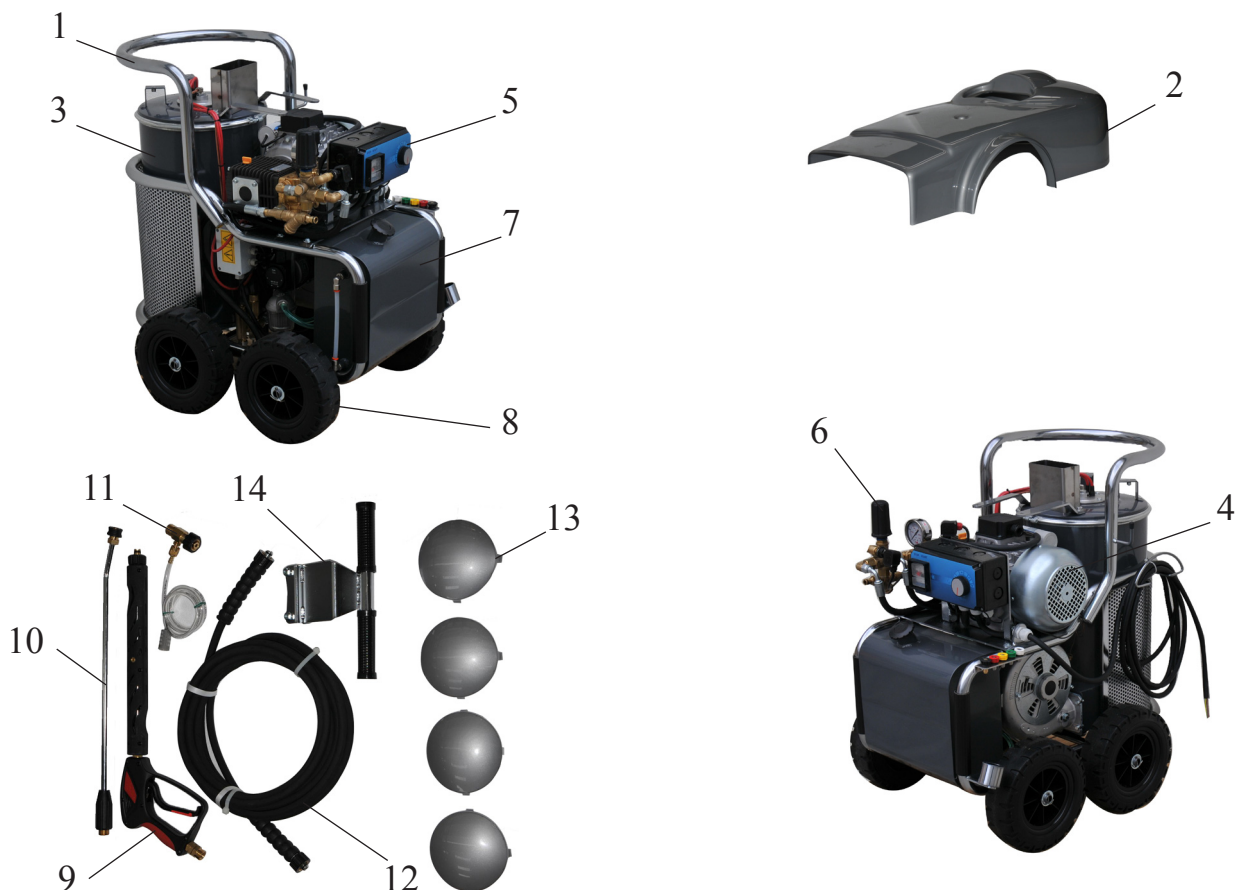



This manual shows the correct use and maintenance of the machine.

### 3-1) INFORMATION

This manual is an essential document for the safe use of the equipment. It should be kept in a safe place and must be accessible to the user / repairer to ensure the correct use of the machine and thereby avoid any risks through incorrect Installation, misuse or negligence.

This manual should always be available to the user and / or maintenance, which must be informed about the correct use of the machine and any residual risks. The instructions in this manual does not supersede the safety and technical data, installation and also use for operating, which are applied directly on the machine.

The user must follow the safety regulations to the country of installation, in addition to the rules dictated by common sense.

You should not use the machine if you experience any defects or damage that could compromise the original security; the responsible for the installation, the user or maintenance technician has to report any anomalies to the manufacturer.

The machine is built for specific applications. Should not be changed and / or used for applications different than those specified in the field of use.

Instructions, drawings, tables and all that is contained in the following documents are of technical nature, and therefore any confidential information can not be provided to third parties without the written permission of IDROBASE which is the sole owner.

Descriptions and illustrations contained in this publication does not mean demanding; IDROBASE therefore reserves the right to make changes at any time to bodies, details, accessories supplies, appropriate for any manufacturing or commercial improvement.



## 4-1) TECHNICAL DATA

The following table describes the models and specifications of the machine.

### TECNICAL DATA

MODEL	Pressure (bar)	Flow-rate (l/min.)	Power (Kw)	Temperature ( Max °C )	Weight (kg)
1000-100/11	100	11	2.2	90	160
1000-200/15	200	15	5.5	80	165

### OVERALL DIMENSIONS (cm)

A	B	C
570	1130	890

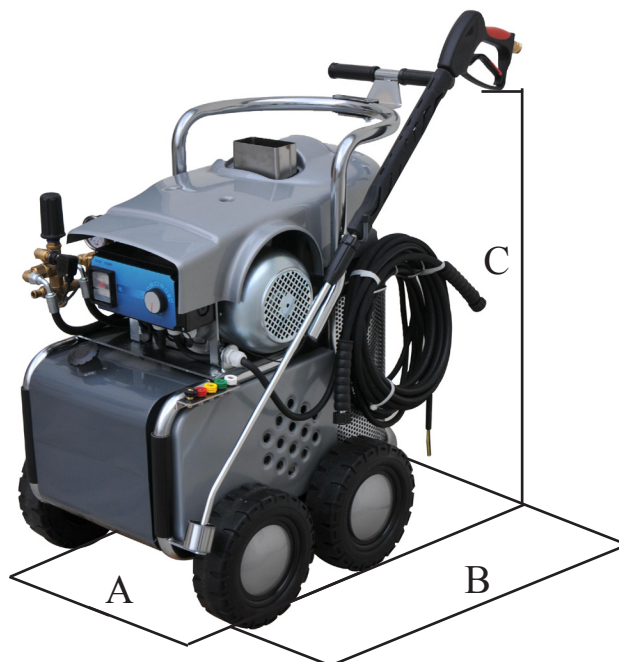

### 5-1) UNPACKING

The machine is packed in a plain cardboard box for protection..  
The cardboard can be removed with the appropriate equipment; however, cellophane, staples and adhesive tape can cut or injure if not handled with care. The machine should be unpacked and set up on a level surface, near a drain & water supply and the components carefully checked.

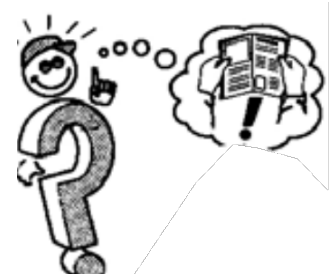

#### WARNING:

Use the appropriate safety equipment and give maximum care in the opening of the packaging.  
Straps or staples if not handled with care can cause injury.

The disposal of the packaging must be carried out to conform to all local laws and regulations. After having unpacked the machine make sure that the pressure washer is complete, including all of the requested accessories.

### 5-2) INACTIVITY

During a period of inactivity store the machine in a cool, dry place not below 5 °C.



#### WARNING:

The pressure washer does not function in extreme cold. If storing in a cold environment with a temperature less than 5 °C, antifreeze must be introduced into the machine while running, and only after having consulted a qualified technician. The use of unsuitable antifreeze can damage the seals in the pump. To disregard these instructions can seriously damage the pressure washer.

### 5-3) TRANSPORT

The machine comes delivered on a wooden pallet and covered with cardboard packaging, firmly bound with plastic straps by staples.

The machine is usually transported by truck. The unloading of the truck is carried out by means of fork-lift truck with appropriate equipment, or manually using appropriate equipment while respecting the normal health and safety regulations.

### 5-4) HANDLING

Always use a fork-lift truck to move or handle the machine.

### 5-5) STANDARD EQUIPMENT

Check that the packaging contains the following components:

- High pressure washer
- High pressure hose with quick connection M22x1.5
- Gun
- Lance
- Injector
- Unit handle
- Wheel studs

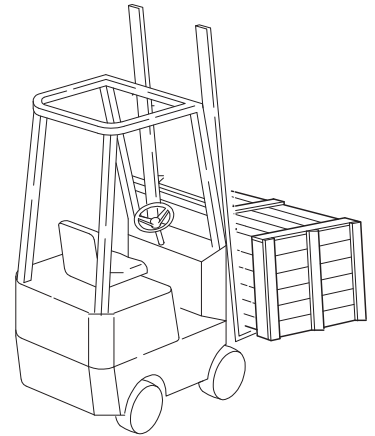

### 5-6) INSTALLATION AND CONNECTION

For easier understanding of the operation and of the terms used, refer to the illustration in section 2-2 on page 9.

## MOUNTING ACCESSORIES

- 1 Unroll the high pressure tube and insert the connection to the nipple and tighten by hand.
- 2 Screw the other end of the lance onto the thread of the gun and tighten by hand.
- 3 Assemble the handle
- 4 Assemble the wheels' studs
- 5 Assemble the injector

## CONNECTION AND INSTALLATION OF THE WATER SUPPLY

- 6 Connect the "Stella" to a source of clean water at a minimum pressure of 2 bar.
- 7 The quantity of the water supply must be at least three times the maximum capacity of the "Stella".
- 8 The water that feeds the "Stella" must be free from any impurities. If impurities exist, they must not exceed 50 microns. Otherwise you have to adopt a proper filtration system.
- 9 The hardness of the water must be within the following values: from 7° F to 14° F.

## CONNECTION AND INSTALLATION OF THE ELECTRICAL SUPPLY

- 10 The power supply must respond to the rating of the "Stella".
- 11 The "Stella" must be properly connected to an efficient grounded system matching and combined with a circuit breaker with a sensitivity of  $\leq 30\text{mA}$  in "A" class.
- 12 The electrical connection must be done in accordance with the IEC 309 Rule and without the use of extensions.

## PRELIMINARY CHECK AND FIRST START

- 13 Put the pressure washer in a stable position on a flat and dry surface.
- 14 Make sure that the electric plug of the pressure washer has not been inserted into the socket of the general switch.
- 15 Make sure that the electric switch and the thermostat regulator of the pressure washer are in the OFF position.
- 16 In case you fill up the tank of the pressure washer using a can, make sure that it doesn't contain impurities or water.
- 17 Never let the fuel tank empty.
- 18 Turn the water supply tap on, and make sure that there aren't any drippings.
- 19 Make sure that the detergent tap is closed
- 20 Turn the general switch on I position (ON).

**WARNING:**

Before starting the pressure washer put on suitable protective clothing that will not interfere with the high pressure jet. Do not use the machine if in the presence of people without suitable protective clothing.

**5-7) CLEANING AND DISINFECTING**

To clean the machine use only liquid detergents. The use of other detergents can impair the safety and correct operation of the machine.

Check that the water filters that are used with the machine are of the correct size and that they are periodically removed, checked, and cleaned.

**5-8) REINSTALLATION AND REUSE**

To reuse the machine after a period of inactivity carry out the steps in section 5-7 “Setting up”

**5-9) DESTRUCTION AND DISPOSAL****WARNING:**

The destruction of the pressure washer must only be carried out by a qualified person or by a qualified technician.

When it has been decided to destroy the machine and to render it unusable, empty the contents of the fuel tank, and drain the lubricating oil from the high pressure pump.

It is recommended that all parts which could be dangerous are rendered safe, removing all of the electrical components, while conforming to current legislation regarding the scrapping of these materials. The various components should be disposed of at an appropriate recycling centre.



THE DISPOSAL OF THE MACHINE MUST BE CARRIED OUT ACCORDING TO THE LAWS OF  
THE COUNTRY IN WHICH IT IS TO BE DISPOSED

FOR MORE INFORMATION CALL +39 049 933 5903

### 6-1) DESCRIPTION OF OPERATION

The pressure cleaner is ready for use only after having carried out the steps 1 to 12 detailed in section 5-6. Starting up the pressure washer will first increase the pressure and if required the temperature of the water to the maximum values found in the technical data table, and then discharge a volume of water according to the quantity described in section 2-1 "USES" and in the section 6-3 "Intended Usage".

### 6-2) RANGE OF APPLICATIONS

The pressure washer "STELLA MAGGIORE" is the optimum product for all businesses who require a more reliable, durable and safe pressure washer, that can be used continuously for up to 12 hours a day.

### 6-3) INTENDED USAGE

The pressure washer is designed for the following uses:

- cleaning machines such as industrial vehicles for the transportation of goods and people, trains, hulls of boats, lorries and trailers, buildings, persistent dirt with or without the use of detergents
- descaling in general, unblocking of hoses using suitable accessories from the manufacturer
- washing pavements and floors



1. Do not leave the "Stella" for more than three continuous minutes in BY-PASS.
2. Do not leave the "Stella" in the "TOTAL STOP" position without the presence of the operator.
3. Do not leave the "Stella" in the "TOTAL STOP" position when there is loss of water from the hose, from the gun/nozzle.
4. Do not leave the "Stella" in environmental conditions with a low temperature (below 5° C).
5. Do not remove the gun, the lance or hose without first relieving the pressure
6. Do "NEVER" tamper with the setting of the BY-PASS valve. The right setting is made from the producer and never can be change.
7. Do never close the gun when it works in the steam position.
8. Do never stop the "Stella" after working in the steam position and without having first cooled it down.
9. Do not use the "Stella" with water in which impurities are bigger than 50 microns.



**WARNING:**

If you have to use this machine inside vehicles, boats, trains, or aeroplanes consult the technical department of the manufacturer, because further instructions may be required.

**WARNING:**

Every other use is inappropriate! The manufacturer can not be considered responsible for any damage resulting from improper use or from failing to observe the instructions in this manual.

## 6-4) WORKING LIMITS

Prolonged inactivity (machine stopped) in temperatures less than 5°C (5 degrees centigrade) can cause damage or breakage to the pump, hoses, and to the parts in general. It is therefore advisable to completely empty the machine. Read the warning notice in section 5-2 of this manual and if more information is required contact the retailer or manufacturer.

## 6-5) POSITIONING OF THE OPERATOR AND DANGER AREAS

The machine is equipped with a 10 metre long High Pressure hose so the operator never loses sight of the machine and the relevant electrical and hydraulic connections, he can move around freely and wash within this area.



### WARNING:

The pressure washer has an exhaust for the evacuation of exhaust fumes that is considered a DANGER AREA because it emits hot fumes from the combustion of diesel. **DO NOT TOUCH** the exhaust because it can be very hot and it is **EXPRESSLY FORBIDDEN** to cover the exhaust with objects, clothes, or any other items. Do not expose the face or any other part of the body to the exhaust fumes.

### WARNING:

The pressure washer produces a jet of high pressure water from the nozzle at the end of the lance that is considered a DANGER AREA because it can produce serious damage due to the high force of the water.

### IT IS EXPRESSLY FORBIDDEN

to direct the jet against people or parts of the body, animals or fragile objects. The failure to observe this warning can cause serious injury or damage like cuts and lacerations.

The manufacturer can not be held liable for any damage, accidents or injuries to people or animals due to the disregard of this prohibition

## 6-6) SAFETY FEATURES AND WARNING INDICATIONS

The pressure washer is equipped with the following safety features:

**A- PROTECTIVE AMMETER:** it is an integrated safety feature of the power switch that turns off the pressure cleaner in case of electrical overload, automatically tripping the power switch into the OFF position.

Whenever this safety feature is activated this sequence must be followed:

- remove the plug from the wall socket
- press the trigger on the pressure cleaner to release any residual pressure remaining
- wait for 10 minutes for the pressure washer to cool down
- disconnect the electric plug and verify that it complies with the instructions contained in the paragraph "Connection and installation of the electricity supply," checking the extension lead used.
- reconnect the electric plug and repeat the procedure for start up described in the aragraph, "initial activity and start-up"

**NEVER direct spray jet at any surface that may contain asbestos material.**



B- SAFETY VALVE: is a maximum pressure valve, correctly calibrated by the manufacturer, that discharges excess pressure whenever you need to check an anomaly in the pressure regulating system.



**WARNING:**

In case of repeated intervention by the safety systems, do not use the pressure washer before having it checked by a qualified technician

C- PRESSURE REGULATING VALVE: is a valve, correctly calibrated by the Manufacturer, that prevents the pressure from increasing past the maximum value allowed, by recirculating the excess water through the pump.

D- LOCKING MECHANISM FOR THE GUN TRIGGER: is a safety catch that allows you to lock the trigger of the gun in the closed position, preventing accidental use.

Furthermore, on the machine there are a series of adhesive labels on the casing and on the protective cover for the belt drive that prohibit the use of the pressure washer without the respective protection.

Refer to section 1-8 for the complete description of the graphical symbols.

E- the THERMOSTAT : device that operates the boiler and manages the regulation of the temperature.

F- FLOW SWITCH : device that detects the passage of water internally within a line.

G- PRESSURE SWITCH : device that detects the pressure difference in the water inlet and outlet.

## 6-7) PERSISTENT HAZARDS

The pressure washer was designed to eliminate as much as possible any cause of danger when in use, however:

- RISK OF BURNS from the heating unit exhaust, described in the warning section of this manual and indicated below. This label is placed on the casing of the machine near the danger.

- RISK OF INJURY from the nozzle at the end of the lance, described in the warning section of this manual and indicated below. This label is placed on the casing of the machine near the danger.

## 6-8) SAFETY GEAR FOR THE OPERATOR

During the running of the pressure washer it is obligatory to wear the following safety gear:

- goggles, if possible a protective mask
- boots with anti-slip soles
- safety gloves

## 6-9) TRAINING

It is the responsibility of the proprietor and/or supervisor to assign an operator and train them in the use of the pressure washer according to the instructions in this manual.

**THE MACHINE MUST ONLY BE OPERATED BY A TRAINED OPERATOR, WHO USES THE MACHINE IN ACCORDANCE WITH THE INSTRUCTIONS CONTAINED IN THIS MANUAL AND/OR THE MANUAL FOR ANY EXTERNAL EQUIPMENT.**

## 7) USER INSTRUCTIONS



THE MANUFACTURER DOES NOT ACCEPT ANY RESPONSIBILITY FOR ANY IMPROPER USE OF THE MACHINE NOT FORESEEN IN THIS MANUAL

### 7-1) DESCRIPTION OF THE SAFETY CONTROLS

The high pressure washer is equipped with a watertight control panel where there is the power switch (ON-OFF), the thermostat to regulate the water temperature, and the electrical connections to the motors and the control/adjustment components

Refer to the electrical diagram in section 12 for the graphical representation of the components.

### 7-2) MANOEUVRING DESCRIPTION TO BE CARRIED OUT AND OPERATION

After going through all the operating stages listed in chapters 5-6 and from point 1 to 12, to get the h.p washer to start:

13 Turn on the “Stella” with the general switch, keep the gun open and wait for the pressure to go steady.

14 Turn on the burner with the thermostat knob and position it at the desired temperature.

15 The first step to turn off the “Stella” is to turn OFF the burner by putting the thermostat knob on the “OFF” position, wait for the water coming out to become cold, then you can continue with turning off the “Stella”.

16 Turn on the “Stella” with the general switch, keep the gun open and wait for the pressure to go steady

17 Adjust the BY-PASS valve in the “STEAM STAGE” position.

18 Turn on the burner via the thermostat and position it at the desired temperature

19 During the washing operation with steam, do never close the gun.

20 The first step to turn off the “Stella” is to turn off the burner by putting the thermostat knob on the “OFF” position, wait for the water coming out to be cold, then you can close the gun and continue with turning off the “Stella”.



#### WARNING:

Care and attention must be taken when using the pressure washer. The machine must only be used by an operator who has been correctly instructed in its use. Do not allow anyone else to use the pressure washer without first verifying that they have been properly trained in its use, and that they have read this manual and fully understood the instructions for use and the safety regulations.



#### WARNING:

If the pressure washer is used in a closed environment, make sure that the exhaust fumes are expelled in an appropriate way and that there is sufficient ventilation (there is danger of asphyxiation).

#### WARNING:

The machine must not be left running for more than 2 or 3 minutes maximum with the gun trigger in the closed position.

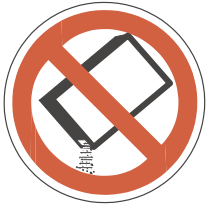

#### USING WITH DETERGENT

The machine was designed to be used with detergents recommended by the manufacturer. The recommended detergents are those that are 90% biodegradable. The use of other detergents or chemical products can negatively affect the safety and the correct running of the pressure washer. To fill the pressure washer with detergent, insert the suction hose (n°14 pag.9) into the tank containing the detergent and open the tap.



#### WARNING

After the use of detergents or disinfectants it is useful to run the machine for a few minutes with clean water, to rinse out the circuit.

#### WARNING

Do not use the pressure washer to suck in any products containing solvents, petrol, thinners, acetone, combustable oils, toxic products or irritants because the vapours are highly inflammable, explosive, toxic or irritant.

Read carefully the instructions and warnings recorded on the label on the detergent used.

#### WARNING:

Keep separate and clearly marked the tanks containing the diesel and the detergents. If one of the tanks is filled with the wrong product, do not use the pressure cleaner and refer to a qualified technician or the retailer for advice

### 7-3) TRIAL STAGE

The “NEW” high pressure washer needs to pass a fast trial stage of the motor-pump group.

The trial stage consists in making the unit run for no longer than 1 hour and then wait for another 1 hour so it cools down. This should be done 5 times.

### 7-4) INTERRUPTING THE RUNNING (TOTAL STOP)

The pressure washer model with total stop will stop running automatically when the trigger on the gun is released.

The pressure washer will restart as soon as the trigger on the gun is pressed..



#### WARNING:

Remember that when the pressure washer is in total stop it is still in effect running.

Do not leave the machine unsupervised even for a short time, without having previously taken the following steps:

- press the power switch to the OFF position
- remove the plug from the wall socket
- close the tap of the water supply

press the trigger on the gun to discharge the residual pressure inside the hoses

## 7-5) WORK STOPPAGE

The pressure washer stops supplying a jet of high pressure water when the trigger on the gun is released. Using this function it is possible to temporarily suspend the washing process.



**WARNING:**

The machine must not be operated with the pistol closed (trigger released) for more than 2 or at max. 3 minutes

**WARNING:**

The machine in this condition is considered to be operating.

**DO NOT REMOVE YOUR GRIP FROM THE GUN.**

## 7-6) REGULATION

The machine is tested by the manufacturer and the working pressure already regulated before being despatched. In case you wish to work with a lower pressure, manually rotate the pressure regulating valve anticlockwise.

In normal working circumstances it is also possible to regulate the temperature of the water jet by adjusting the thermostat control, until the maximum temperature allowed is reached, as recorded in the technical data table (page 11).

Reference to operation of smaller steam units is not allowed.

## 7-7) STOPPING AND PAUSING OPERATION

When you have finished the washing procedure stop the machine and store it according to the following sections

## 7-8) STOPPING OPERATION

- 1 When using a hot water machine, run the pressure washer with cold water for a few minutes by turning the thermostat to 0°C (zero °C)
- 2 Completely close the tap connected to the water supply.
- 3 Empty the pressure washer of any residual water by pressing the trigger of the gun for a few seconds
- 4 Turn the power switch to the OFF position
- 5 Remove the plug from the wall socket.
- 6 Eliminate any remaining pressure in the high pressure hose by keeping pressed the trigger on the gun for a few seconds

## 7-9) EMERGENCY STOP

To carry out an emergency stop press the ON-OFF switch on the control panel to the OFF position

## 7-10) RESETTING CONDITIONS

To reset the initial conditions refer to the section “7.2 DESCRIPTION OF THE OPERATIONS”

## 7-11) STORAGE OPERATION

7 Wait for the pressure washer to cool, taking care not to leave it unattended or near inflammable materials.

8 Carefully re-wind the power cable.

9 Remove the water hose from the tap

10 Carefully re-wind the high pressure hose, while avoiding twisting or bending.

11 Store the pressure washer in a level, clean, dry place.



### WARNING:

The pressure washer cannot withstand very cold temperatures. Do not leave the machine in an environment in which the temperature is less than 5°C.

In case of storage in a cold environment, with a temperature less than 5°C, first follow the procedure for stopping the machine, and only after having consulted a qualified technician is it possible to use antifreeze in the pressure washer.

Unsuitable liquid antifreeze can damage the seals of the pump.

The failure to respect these simple precautions can cause serious damage to the pressure washer.



**WARNING:**

Every time the pressure washer is cleaned or maintained it must first be stopped by following the steps described in paragraph 6-1.  
To guarantee machine safety, you are advised to use only spare parts authorised by the manufacturer. **DO NOT CARRY OUT TEMPORARY OR DANGEROUS REPAIRS.**

## 8-1) REGULAR MAINTENANCE



**CAUTION:**

During operation, the system must maintain a noise level that complies with legislation. Furthermore, there must be no water leakage from the pumping module or the lines.

MAINTENANCE FREQUENCY	INTERVENTION
Each time the system is used	- Check that the cables of the relative plugs are in a good state of repair. - Verify also that the water hose, high pressure hose, connections, gun and lance are in excellent condition. NB: If one or more of these components are damaged do not use the machine and consult a qualified technician
Every 50 ours	-Cleaning the water suction filter. For general cleaning it is sufficient to pass the filter under running water or blow with an air compressor. In more difficult cases use a descaling product, or purchase a replacement filter from a recommended spare parts centre or from the retailer - Cleaning of the fuel filter. For a general cleaning, it is enough to disassemble the containment glass, remove the cartridge, and using compressed air you can clean the filter.

## 8-2) EXTRAORDINARY MAINTENANCE

CAUTION: Extraordinary maintenance should only be performed only by a specialized technician.

MAINTENANCE FREQUENCY	INTERVENTION
Every 500 hours	<ul style="list-style-type: none"><li>- Replace the pump oil (see section 7-3 for the type of oil to use)</li><li>- Clean or replace the diesel filter: cup, pump and nozzle</li><li>- Adjustment or replacement of the electrodes</li><li>- Clean the heater</li><li>- Check the tension in the drive belt</li><li>- Check the pump is securely fixed</li><li>- Check the motor is securely fixed</li><li>- Check the safety systems</li><li>- Check the pressure regulating valve</li></ul>

## 8-3) TECHNICAL INFORMATION

MODELL	FLOW RATE l/min	CAPACITY gasolio-Litri	OIL PUMP	QUANTITY
1000-100/11	11	20	SAE 75W90	0,5 lt.
1000-200/15	15	20	SAE 75W90	0,5 lt.

FAULT	CAUSES	SOLUTION
<p>The pressure washer does not start when the power switch is pressed. Remember what you have read in section 7-4 interruption of running (TOTAL STOP)</p>	<p>A safety feature to which the pressure washer is connected has triggered (fuse, circuit breaker, etc). The power plug is not inserted correctly</p>	<p>Reset or replace the safety feature. In case of repeated interventions do not use the machine and consult a qualified technician. Remove the plug from the socket and insert correctly.</p>
<p>Vibration in delivery piper or in sprayer</p>	<ol style="list-style-type: none"> <li>1) The pump takes in air</li> <li>2) No water supply</li> <li>3) Water filter is dirty or blocked.</li> <li>4) Pump valve damaged</li> </ol>	<ol style="list-style-type: none"> <li>1) Check that all of the hoses are in good condition. If cracked or broken, replace them.</li> <li>2) Check conetion to water mains</li> <li>3) Check the connection to the water supply. Check that the float is not obstructed.If necessary replace it.</li> <li>4) Clean or replace the water filter.</li> <li>5) Call the Service center.</li> </ol>
<p>No water or detergent to the lance even when the pump is working .</p>	<ol style="list-style-type: none"> <li>1) Air in the circuit.</li> <li>2) Lance nozzle is blocked</li> <li>3) No water to the lance</li> <li>4) deergent intake pipe is faulty or badiy fitted</li> </ol>	<ol style="list-style-type: none"> <li>1) Relase air</li> <li>2) Switch off the machine, diassemble the nozzle and clean it.</li> <li>3) Check the water supply circuit</li> <li>4) Check the positioning of the hose or replace it.</li> </ol>
<p>Pressure in the pump is above normal level but the pressure to the lance is weak.</p>	<ol style="list-style-type: none"> <li>1) lance nozzle is blocked</li> <li>2) Circuit is blocked</li> </ol>	<ol style="list-style-type: none"> <li>1) Switch off the machine, diassemble the nozzle and clean it.</li> <li>2) replace or celar the inlet and outlet pipes. if necessary, call the service center for a check on the machine</li> </ol>
<p>The machine ( motor/pump unit ) won't start</p>	<ol style="list-style-type: none"> <li>1) Mains voltage too low.</li> <li>2) Gun deactivated or swich is turned OFF.</li> <li>3) Circuit breaker has triggered</li> <li>4) Power supply failur</li> </ol>	<ol style="list-style-type: none"> <li>1 Check eletric connection</li> <li>2 Active lance / Push the power switch</li> <li>3 Active the lance In case of repeated interventions do not use the machine and consult a qualified technician.</li> <li>4 Check the power supply and connect the machine again</li> </ol>
<p>BOILER</p>		
<p>Blocked burner</p>	<ol style="list-style-type: none"> <li>1) No diesel fuel is supplied</li> <li>2) No spark.</li> </ol>	<ol style="list-style-type: none"> <li>1) Check de fuel level.</li> <li>2) Make sure the filter is not blocked and that no air comes in the circuit</li> <li>3) Check integrity of motor-pump coupling</li> <li>4) Make sure the pump has not stopped.</li> <li>1) Check the start up transformer</li> <li>2) Check the position of electrodes</li> </ol>
<p>wihte smoke from the boiler (even when the running tempe-rature has been reached)</p>	<ol style="list-style-type: none"> <li>1) Air in excess in the comburent</li> </ol>	<ol style="list-style-type: none"> <li>1) Adjust he pressure of diesel fuel (10 bar)</li> </ol>



### 10-1) SPARE PARTS

The user is not authorised for any reason to interfere with the machine with the exception of carrying out ordinary maintenance detailed in this instruction manual.

For possible repairs seek advice from the manufacturer.

### 10-2) SPARE PARTS

The pressure washer comes delivered with this instruction manual with the “spare parts booklet” enclosed. You can find the codes of particular spare parts in the corresponding section.

## 11-1) DESTRUCTION AND DISPOSAL

When the machine is no longer required for use it is recommended that it is rendered inoperative by cutting the power cable.

It is recommended that the parts that can be dangerous are rendered safe, for example: remove all electrical parts while following current legislation regarding their disposal. Remove scrap iron and take to a recycling centre.

Schema elettrico trifase con total stop  
 Three-phases electric schema with total stop switch

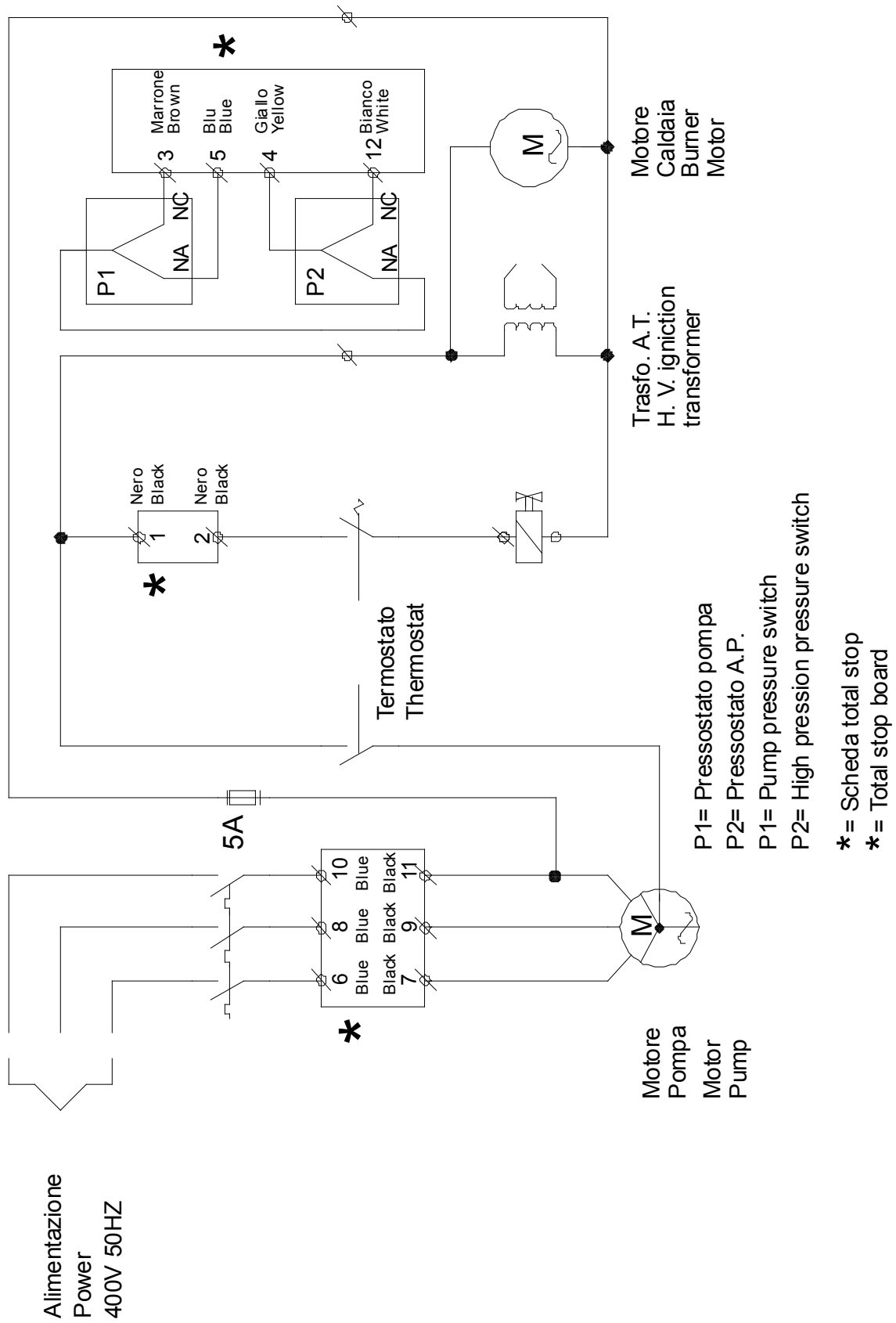

Schema elettrico monofase con total stop  
 Single phase electric schema with total stop switch

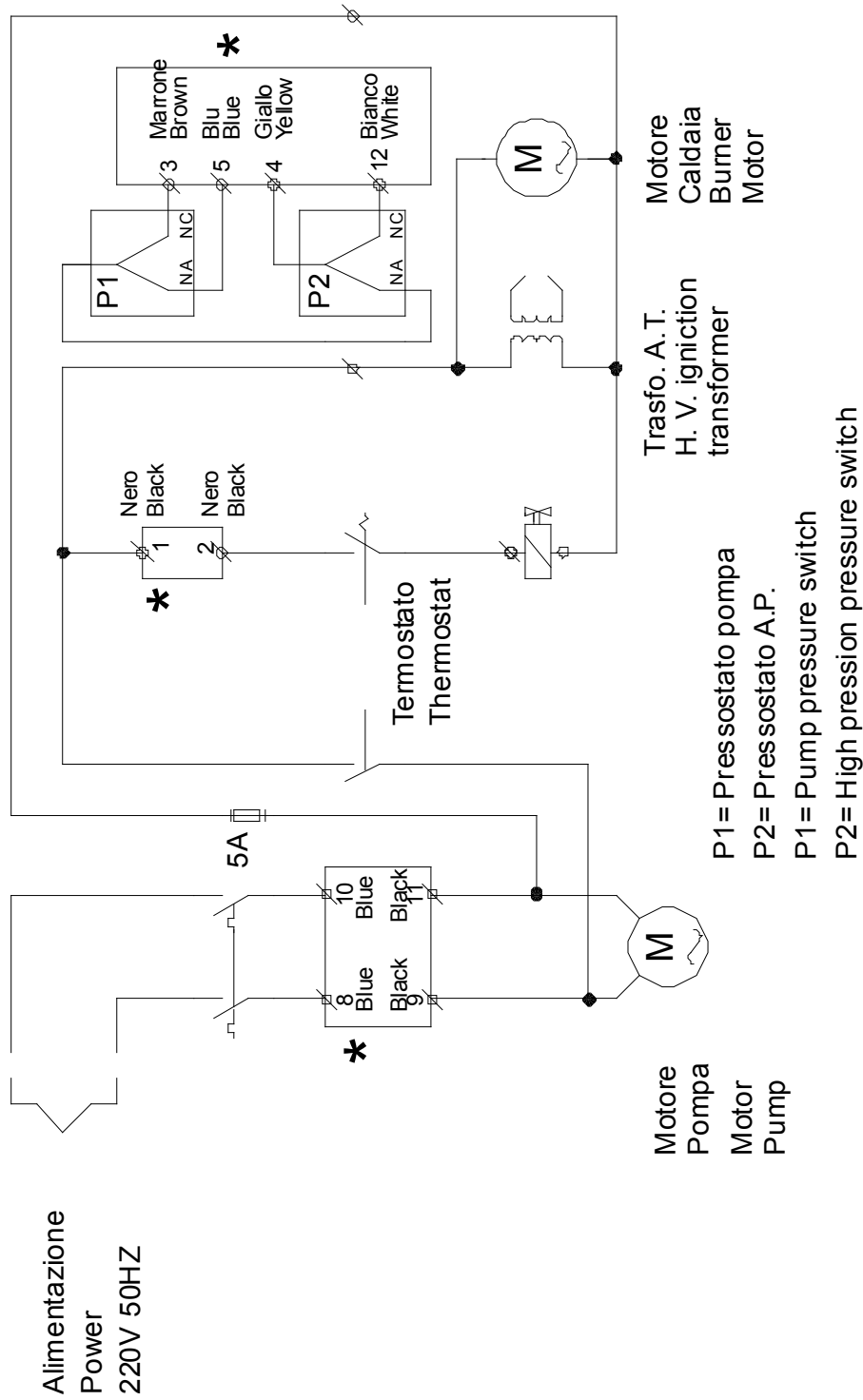

## DECLARATION OF CONFORMITY

Ithe undersigned, representative of the following manufacturer  
 IDROBASE s.r.l. head office in BORGORICCO (PD) - Via del'industria 25



declares that the product:

MODELL :           STELLA

with serial number: \_\_\_\_\_  
 (to be report by the purchaser by relesing to the identification plato)

is in accordance with the following Directive:

89/336 CEE Directive ( EMC Directive) and subsequent emendaments  
 73/23 CEE Directive (Llow Voltage Directive ) and subsequent emendaments  
 98/37/CE Directive ( Macchiney Directive ) and subsequent emendaments

and that all following standards have been applied:

EN 55014-1	EN55014-2	
EN61000-3-2	EN61000-3-3	EN60335-2-79

Place:               BORGORICCO (PD) ITALY

DATE:               25-05-2010

Sign  
 Legal representative







Certificazione di qualità  
Quality assured firm  
n° 9.190 - IDRH - 11/02/2005  
UNI ES ISO 9001:2000

# IDROBASE®

PASSION FOR WATER



idrobaser®



**AUSTRALIAN PUMP INDUSTRIES PTY LTD**

7 Gladstone Road, Castle Hill NSW 2154  
Ph: (02) 9894 4144 Fax: (02) 9894 4240  
website: [www.ausaiopumps.com.au](http://www.ausaiopumps.com.au) Email: [wibrenz@ausaiopumps.com.au](mailto:wibrenz@ausaiopumps.com.au)

**35010 BORGORICCO (PD) ITALY**

35010 BORGORICCO ((PD) ITALIA - Via Dell' Industria, 25 Tel. +39 049 9335903 - Fax +39 049 9335922  
E-mail: [idrobaser@idrobaser.com](mailto:idrobaser@idrobaser.com) - [www.idrobaser.com](http://www.idrobaser.com)